

## CATALOGUE OF SAFE CABINS

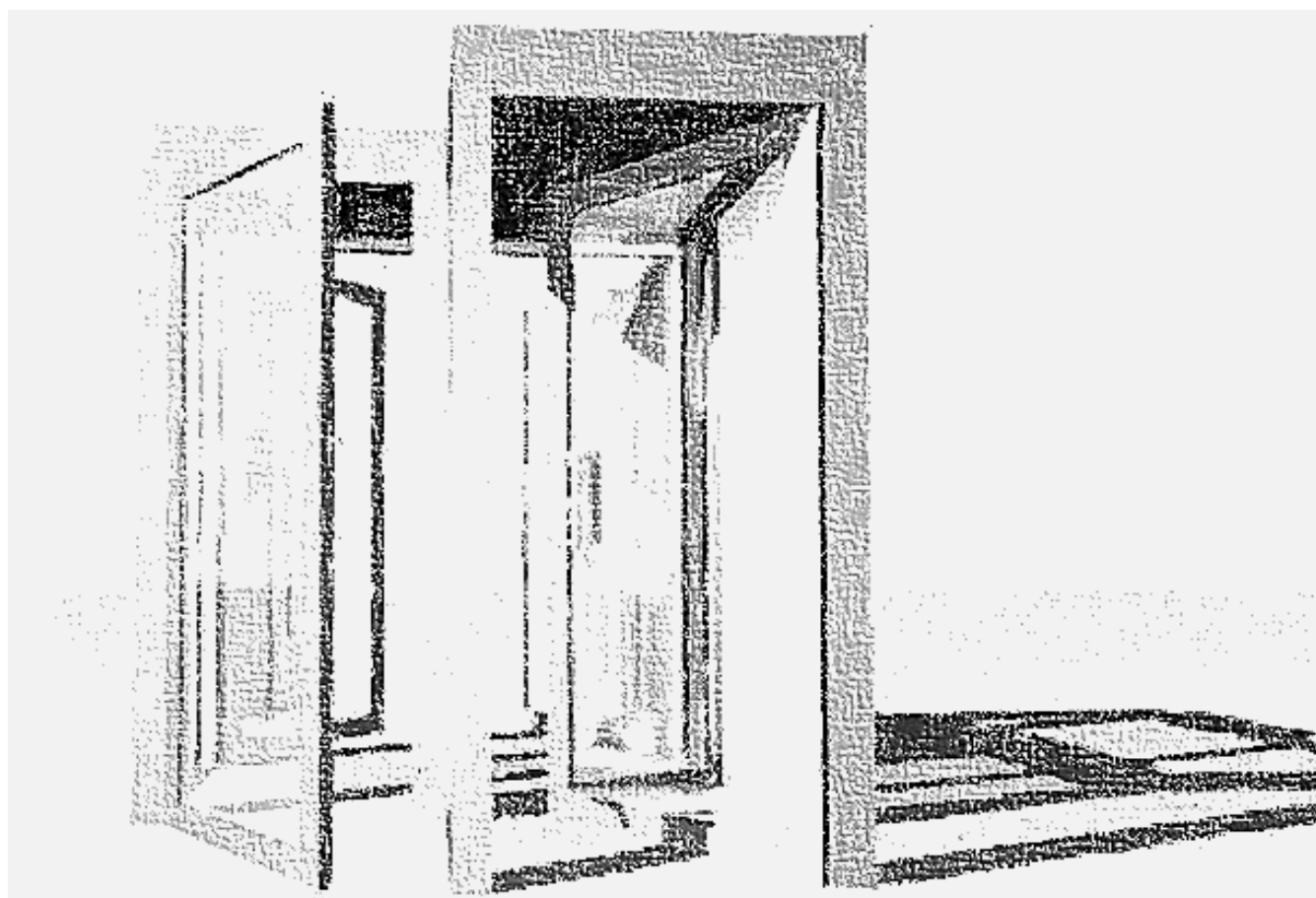

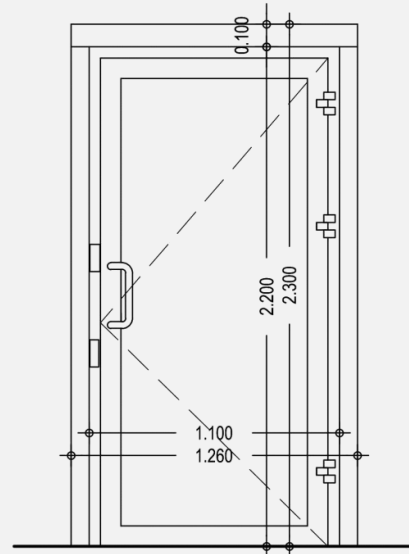
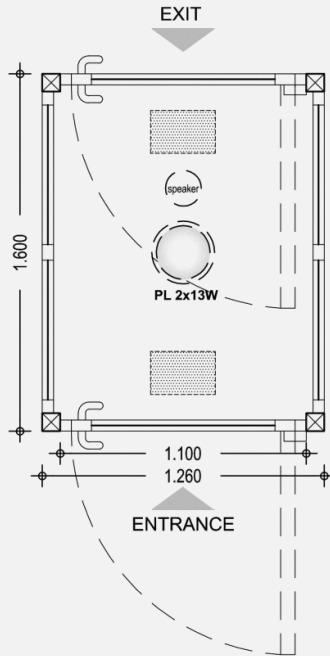

### Technical description: Single Safe Cabin – Standard

<b>Standard dimensions:</b>	1.26 x 1.60 x 2.30 *	<b>Mechanical lock:</b>	Schueco
<b>Aluminum profile:</b>	Schueco ADS 50NI/AWS 50NI certified RC2 as per DIN EN 1627*	<b>Electro-magnetic lock:</b>	with resistance pin against weights over 1000kg, fail-safe and for 1000 openings/day
<b>Glass:</b>	bulletproof/anti-vandal certified P6B as per EN 356 (B) & BR2S as per EN 1063 *	<b>Indicative lights:</b>	red-green with button
<b>Safe cabin roof:</b>	MDF with 19mm thickness, bulletproof sheet cladding , FB2 as per EN 1522 > voice message announcement speaker > PL 2X13W lighting > ventilating shutter	<b>External button for people with Disabilities:</b>	included
<b>Door closer :</b>	sliding arm	<b>Automation system:</b>	> central processing unit > wireless remote controls > wired operation console > voice messaging unit
<b>Hinges:</b>	visible and heavy-duty	<b>Optional fitting/accessories:</b>	> human presence detector > face recognition

\*The dimensions and specifications given are indicative and may be adapted to specific requirements.

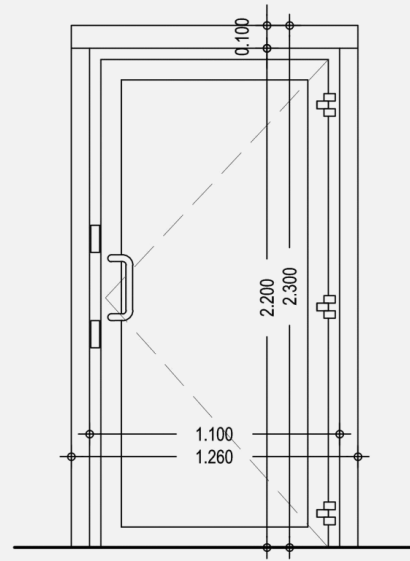
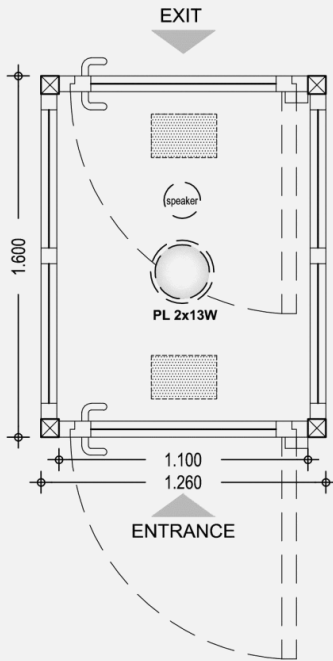

### Technical description: Single Safe Cabin – Standard

<b>Standard dimensions</b>	1.26 x 1.60 x 2.30 *	<b>Mechanical lock:</b>	Schueco - three (3) locking point **
<b>Aluminum profile:</b>	Schueco ADS 65HD certified RC3 as per DIN EN 1627*	<b>Electro-Magnetic lock:</b>	With resistance pin against weights over 1000kg, fail-safe and for 1000 openings/day
<b>Glass:</b>	Bulletproof/anti-vandal certified P7B as per EN 356 (B) & BR3S as per EN 1063 *	<b>Indicative lights:</b>	red- green with button
<b>Safe cabin roof:</b>	MDF with 19mm thickness, bulletproof sheet cladding , FB2 as per EN 1522 > voice message announcement speaker > PL 2X13W lights > ventilating shutter	<b>External button for people with Disabilities:</b>	included
<b>Door Closer:</b>	sliding arm	<b>Automation system:</b>	> central processing unit > wireless remote controls > wired operation console > voice messaging unit
<b>Hinges:</b>	visible & heavy-duty	<b>Optional fitting / accessories:</b>	> human presence detector > face recognition

\*The dimensions and specifications given are indicative and may be adapted to specific requirements.

\*\* Only external doors are fitted with three (3) locking point locks.

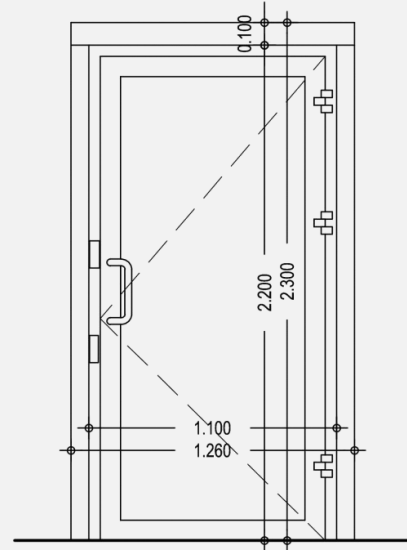
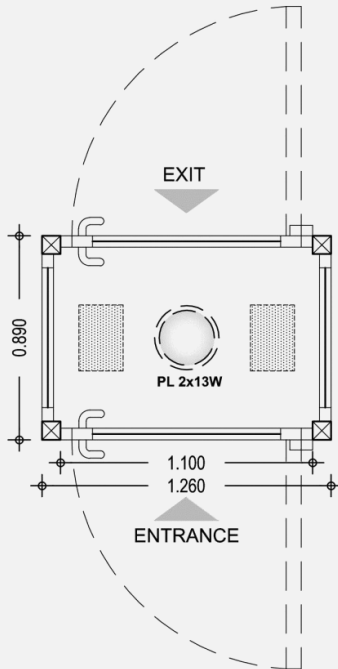

### Technical description: Single Safe Cabin – Narrow

<b>Standard dimensions:</b>	1.26 x 0.89x 2.30 *	<b>Mechanical lock:</b>	Schueco
<b>Aluminum profile:</b>	Schueco ADS 50NI/AWS 50NI certified RC2 as per DIN EN 1627*	<b>Electro-magnetic lock:</b>	with resistance pin against weights over 1000kg, fail-safe and for 1000 openings/day
<b>Glass:</b>	bulletproof/anti-vandal certified P6B as per EN 356 (B) & BR2S as per EN 1063 *	<b>Indicative lights:</b>	red-green with button
<b>Safe cabin roof:</b>	MDF with 19mm thickness bulletproof sheet cladding , FB2 as per EN 1522 > voice message announcement speaker > PL 2X13W lighting > ventilating shutter	<b>External button for people with Disabilities:</b>	included
<b>Door closer :</b>	sliding arm	<b>Automation system:</b>	> central processing unit > wireless remote controls > wired operation console > voice messaging unit
<b>Hinges:</b>	visible and heavy-duty	<b>Optional fitting/accessories:</b>	> human presence detector > face recognition

\*The dimensions and specifications given are indicative and may be adapted to specific requirements.

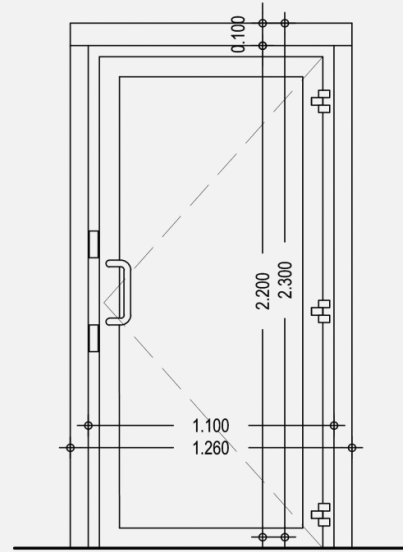
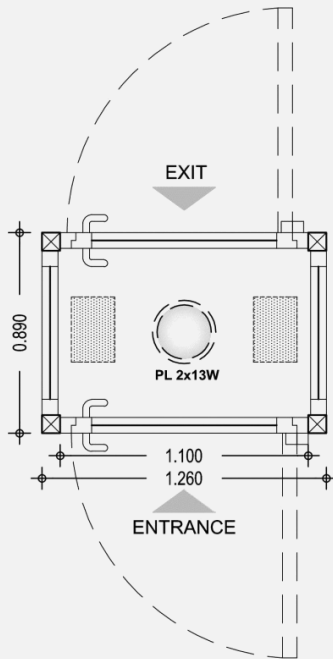

### Technical description: Single Safe Cabin – Narrow

<b>Standard dimensions:</b>	1.26 x 0.89x 2.30 *	<b>Mechanical lock:</b>	Schueco - three (3) locking point **
<b>Aluminum profile:</b>	Schueco ADS 65HD certified RC3 as per DIN EN 1627*	<b>Electro-Magnetic lock:</b>	With resistance pin against weights over 1000kg, fail-safe and for 1000 openings/day
<b>Glass:</b>	Bulletproof/anti-vandal certified P7B as per EN 356 (B) & BR3S as per EN 1063 *	<b>Indicative lights:</b>	red- green with button
<b>Safe cabin roof:</b>	MDF with 19mm thickness bulletproof sheet cladding , FB2 as per EN 1522 > voice message announcement speaker > PL 2X13W lights > ventilating shutter	<b>External button for people with Disabilities:</b>	included
<b>Door Closer:</b>	sliding arm visible & heavy-duty	<b>Automation system:</b>	> central processing unit > wireless remote controls > wired operation console > voice messaging unit
<b>Hinges:</b>		<b>Optional fitting / accessories:</b>	> human presence detector > face recognition

\*The dimensions and specifications given are indicative and may be adapted to specific requirements.

\*\* Only external doors are fitted with three (3) locking point locks.

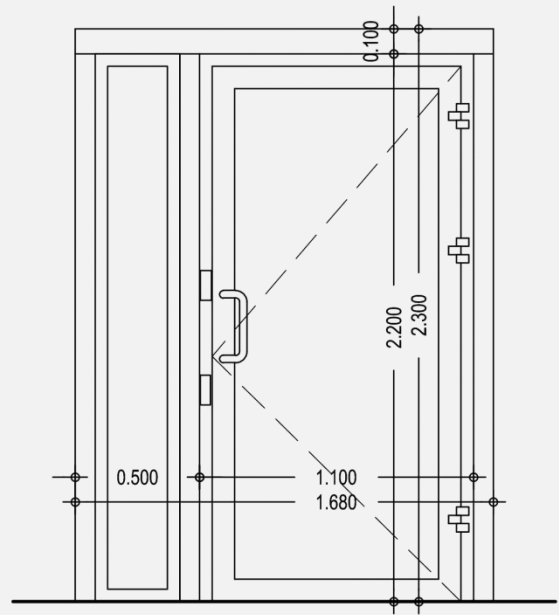
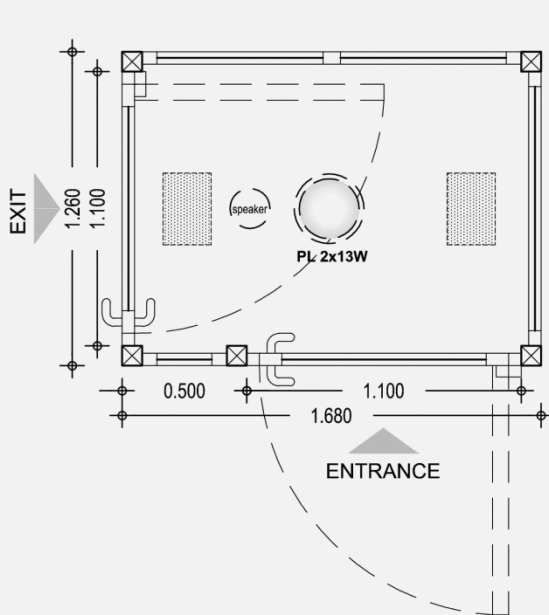

### Technical description: Single Safe Cabin – Angular

<b>Standard dimensions:</b>	1.68 x 1.26 x 2.30	<b>Mechanical lock:</b>	Schueco
<b>Aluminum profile:</b>	Schueco ADS 50NI/AWS 50NI certified RC2 as per DIN EN 1627*	<b>Electro-magnetic lock:</b>	with resistance pin against weights over 1000kg, fail-safe and for 1000 openings/day
<b>Glass:</b>	bulletproof/anti-vandal certified P6B as per EN 356 (B) & BR2S as per EN 1063 *	<b>Indicative lights:</b>	red-green with button
<b>Safe cabin roof:</b>	MDF with 19mm thickness bulletproof sheet cladding , FB2 as per EN 1522 > voice message announcement speaker > PL 2X13W lighting > ventilating shutter	<b>External button for people with Disabilities:</b>	included
<b>Door closer :</b>	sliding arm	<b>Automation system:</b>	> central processing unit > wireless remote controls > wired operation console > voice messaging unit
<b>Hinges:</b>	visible and heavy-duty	<b>Optional fitting/accessories:</b>	> human presence detector > face recognition

\*The dimensions and specifications given are indicative and may be adapted to specific requirements.

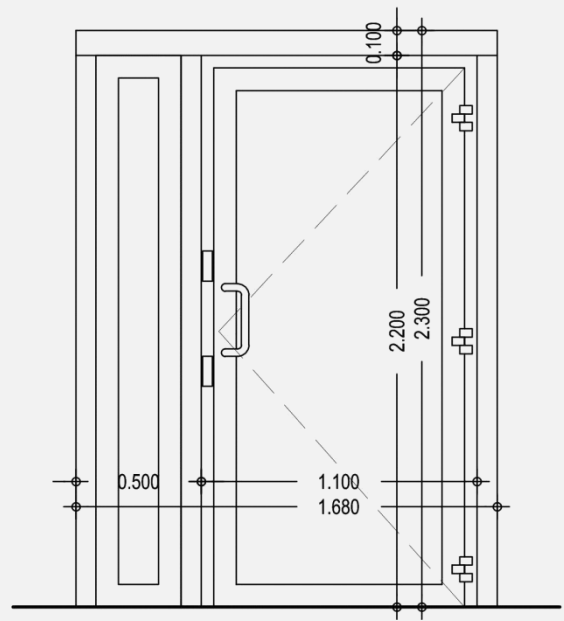
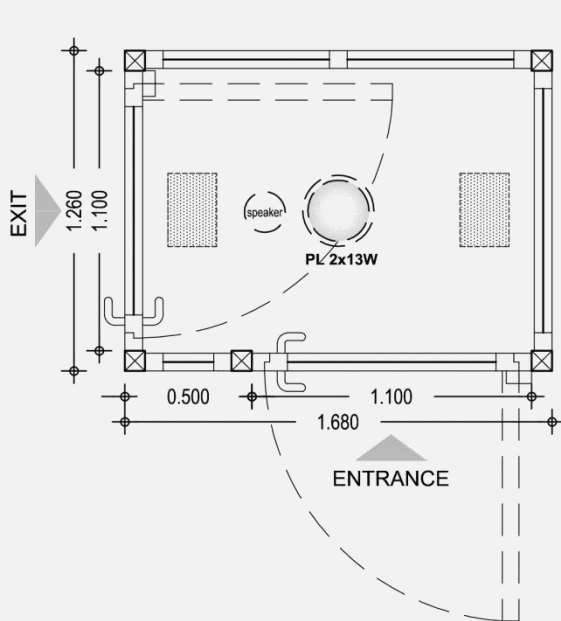

### Technical description: Single Safe Cabin – Angular

<b>Standard dimensions:</b>	1.68 x 1.26 x 2.30 *	<b>Mechanical lock:</b>	Schueco - three (3) locking point **
<b>Aluminum profile:</b>	Schueco ADS 65HD certified RC3 as per DIN EN 1627*	<b>Electro-Magnetic lock:</b>	With resistance pin against weights over 1000kg, fail-safe and for 1000 openings/day
<b>Glass:</b>	Bulletproof/anti-vandal certified P7B as per EN 356 (B) & BR3S as per EN 1063 *	<b>Indicative lights:</b>	red- green with button
<b>Safe cabin roof:</b>	MDF with 19mm thickness, bulletproof sheet cladding , FB2 as per EN 1522 > voice message announcement speaker > PL 2X13W lights > ventilating shutter	<b>External button for people with Disabilities:</b>	included
<b>Door Closer:</b>	sliding arm	<b>Automation system:</b>	> central processing unit > wireless remote controls > wired operation console > voice messaging unit
<b>Hinges:</b>	visible & heavy-duty	<b>Optional fitting / accessories:</b>	> human presence detector > face recognition

\*The dimensions and specifications given are indicative and may be adapted to specific requirements.

\*\* Only external doors are fitted with three (3) locking point locks.

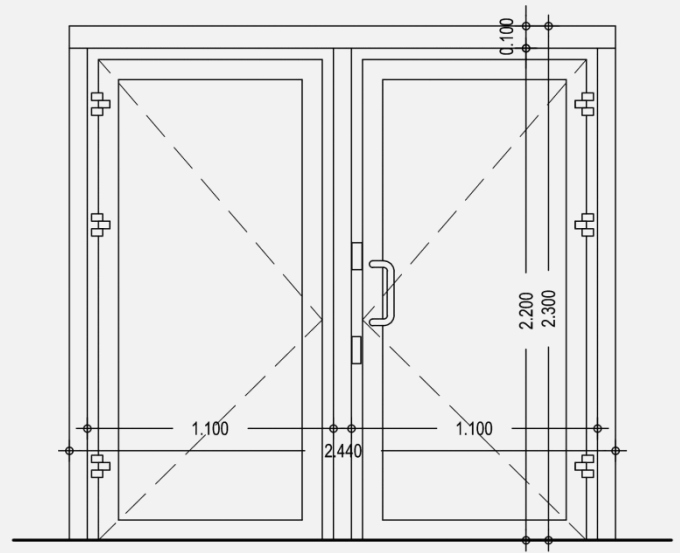
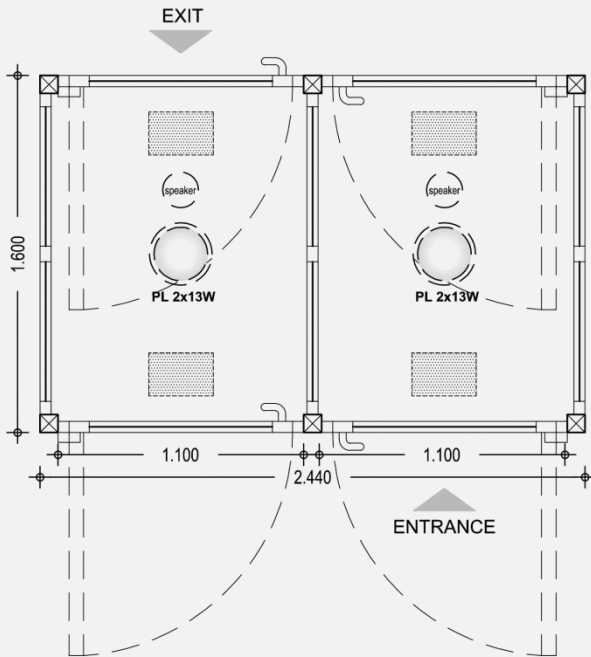

### Technical description: Double Safe Cabin – Standard

#### Standard dimensions:

2.44x 1.60 x 2.30 \*

#### Aluminum profile:

Schueco ADS 50NI/AWS  
50NI certified RC2 as per  
DIN EN 1627\*

#### Glass:

bulletproof/anti-vandal  
certified P6B as per EN  
356 (B) & BR2S as per EN  
1063 \*

#### Safe cabin roof:

MDF with 19mm thickness,  
bulletproof sheet cladding ,  
FB2 as per EN 1522  
> voice message  
announcement speaker  
> PL 2X13W lighting  
> ventilating shutter

#### Door closer :

sliding arm

#### Hinges:

visible and heavy-duty

#### Mechanical lock:

Schueco

#### Electro-magnetic lock:

with resistance pin against  
weights over 1000kg, fail-  
safe and for 1000  
openings/day

#### Indicative lights:

red-green with button

#### External button

for people with Disabilities: included

#### Automation system:

> central processing unit  
> wireless remote controls  
> wired operation console  
> voice messaging unit

#### Optional fitting/accessories:

> human presence detector  
> face recognition

\*The dimensions and specifications given are indicative and may be adapted to specific requirements.



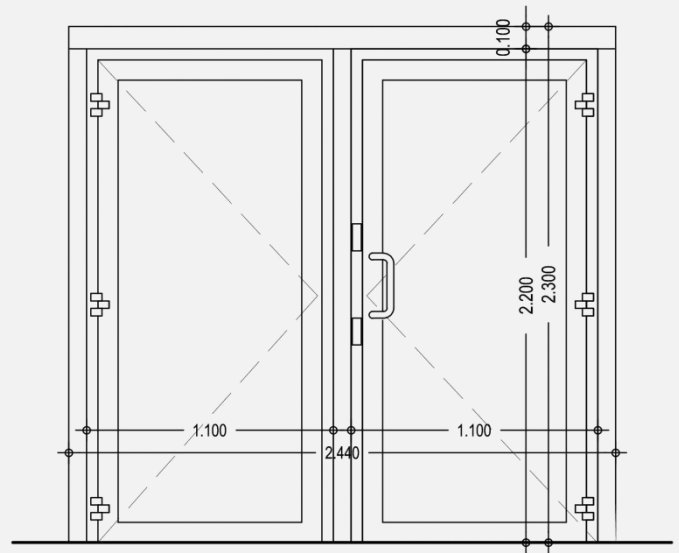
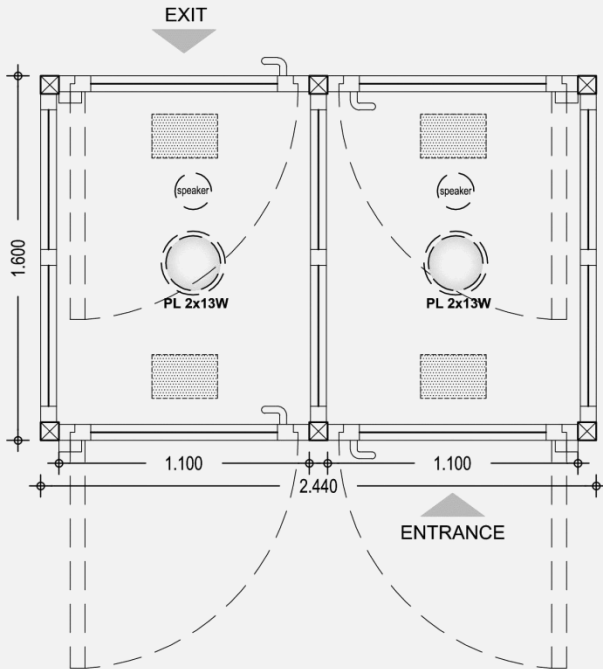

### Technical description: Double Safe Cabin – Standard

<b>Standard dimensions:</b>	2.44 x 1.60 x 2.30 *	<b>Mechanical lock:</b>	Schueco - three (3) locking point **
<b>Aluminum profile:</b>	Schueco ADS 65HD certified RC3 as per DIN EN 1627*	<b>Electro-Magnetic lock:</b>	With resistance pin against weights over 1000kg, fail-safe and for 1000 openings/day
<b>Glass:</b>	Bulletproof/anti-vandal certified P7B as per EN 356 (B) & BR3S as per EN 1063 *	<b>Indicative lights:</b>	red- green with button
<b>Safe cabin roof:</b>	MDF with 19mm thickness, bulletproof sheet cladding , FB2 as per EN 1522 > voice message announcement speaker > PL 2X13W lights > ventilating shutter	<b>External button for people with Disabilities:</b>	included
<b>Door Closer:</b>	sliding arm	<b>Automation system:</b>	> central processing unit > wireless remote controls > wired operation console > voice me
<b>Hinges:</b>	visible & heavy-duty	<b>Optional fitting / accessories:</b>	> human presence detector > face recognition

\*The dimensions and specifications given are indicative and may be adapted to specific requirements.

\*\* Only external doors are fitted with three (3) locking point locks.

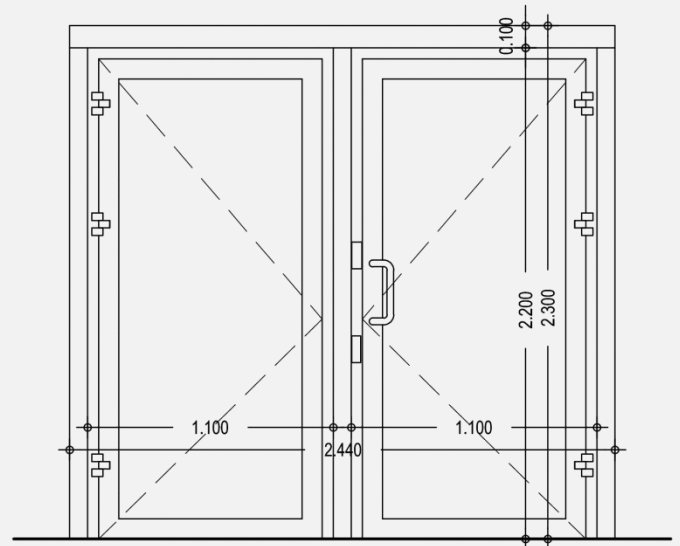
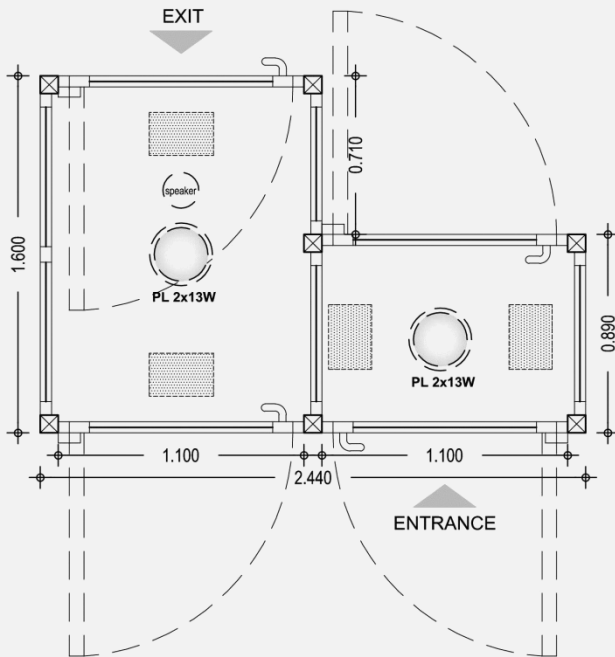

### Technical description: Double Safe Cabin – Scalene (Non-equilateral)

<b>Standard dimensions:</b>	2.44x 1.60 – 0.89 x 2.30 *	<b>Mechanical lock:</b>	Schueco
<b>Aluminum profile:</b>	Schueco ADS 50NI/AWS 50NI certified RC2 as per DIN EN 1627*	<b>Electro-magnetic lock:</b>	with resistance pin against weights over 1000kg, fail-safe and for 1000 openings/day
<b>Glass:</b>	bulletproof/anti-vandal certified P6B as per EN 356 (B) & BR2S as per EN 1063 *	<b>Indicative lights:</b>	red-green with button
<b>Safe cabin roof:</b>	MDF with 19mm thickness, bulletproof sheet cladding , FB2 as per EN 1522 > voice message announcement speaker > PL 2X13W lighting > ventilating shutter	<b>External button for people with Disabilities:</b>	included
<b>Door closer :</b>	sliding arm	<b>Automation system:</b>	> central processing unit > wireless remote controls > wired operation console > voice messaging unit
<b>Hinges:</b>	visible and heavy-duty	<b>Optional fitting/accessories:</b>	> human presence detector > face recognition

\*The dimensions and specifications given are indicative and may be adapted to specific requirements.

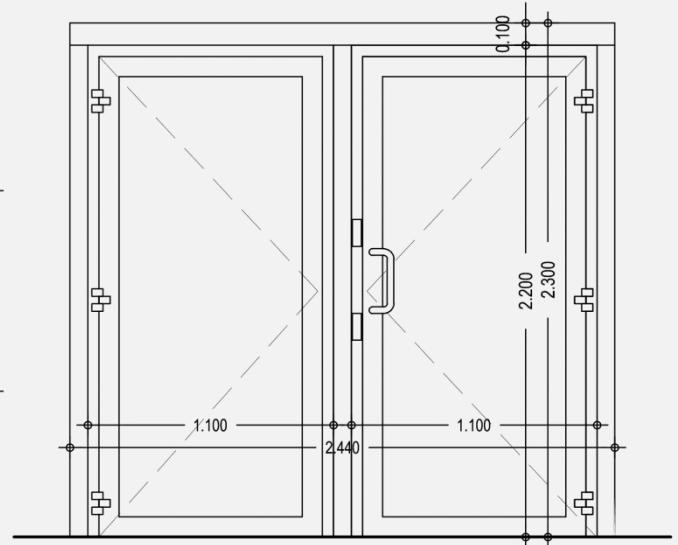
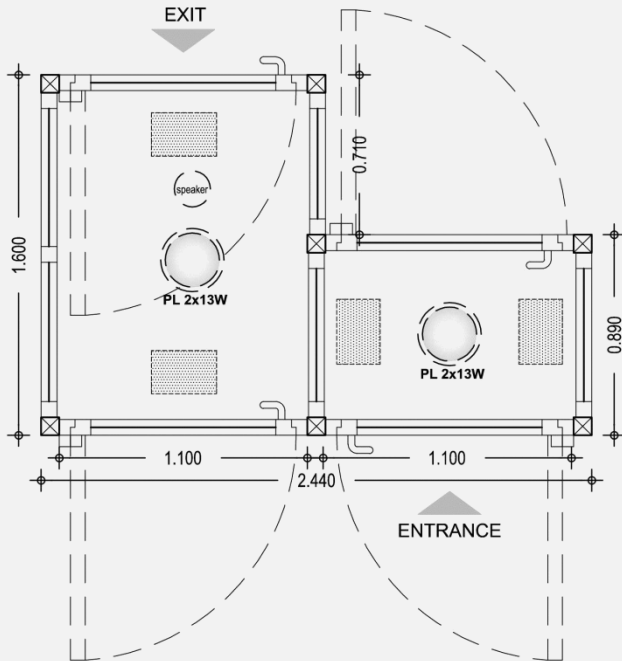

### Technical description: Double Safe Cabin – Scalene (Non-equilateral)

<b>Standard dimensions:</b>	2.44 x 1.60 – 0.89 x 2.30 *	<b>Mechanical lock:</b>	Schueco - three (3) locking point **
<b>Aluminum profile:</b>	Schueco ADS 65HD certified RC3 as per DIN EN 1627*	<b>Electro-Magnetic lock:</b>	With resistance pin against weights over 1000kg, fail-safe and for 1000 openings/day
<b>Glass:</b>	Bulletproof/anti-vandal certified P7B as per EN 356 (B) & BR3S as per EN 1063 *	<b>Indicative lights:</b>	red- green with button
<b>Safe cabin roof:</b>	MDF with 19mm thickness, bulletproof sheet cladding, FB2 as per EN 1522 > voice message announcement speaker > PL 2X13W lights > ventilating shutter	<b>External button for people with Disabilities:</b>	included
<b>Door Closer:</b>	sliding arm	<b>Automation system:</b>	> central processing unit > wireless remote controls > wired operation console > voice me
<b>Hinges:</b>	visible & heavy-duty	<b>Optional fitting / accessories:</b>	> human presence detector > face recognition

\*The dimensions and specifications given are indicative and may be adapted to specific requirements.

\*\* Only external doors are fitted with three (3) locking point locks.